



INSTALLATION AND LOGIN INSTRUCTIONS

Usable Devices

- All Android Devices
 - pg.3
- Amazon Devices:
 - pg. 9
 - Fire TV Stick 4K
 - Fire TV Stick (GEN 1, 2)
 - Fire TV Cube
 - Fire TV Edition (4K, HD)
 - Fire TV (Gen 1, 2, 3)
- Apple Devices
 - pg. 19
- Lost Confirmation E-mail: How to obtain codes
 - pg. 23

Installation and login instructions for **Android Device's**

1. Open Google Chrome Browser

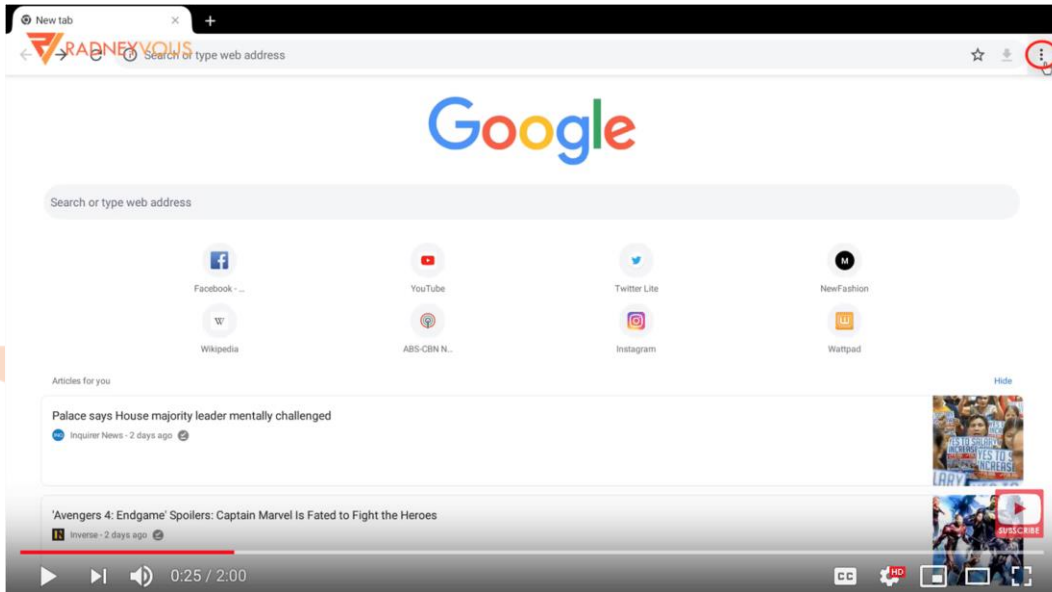

1. Using ellipsis button a. Open “downloads”

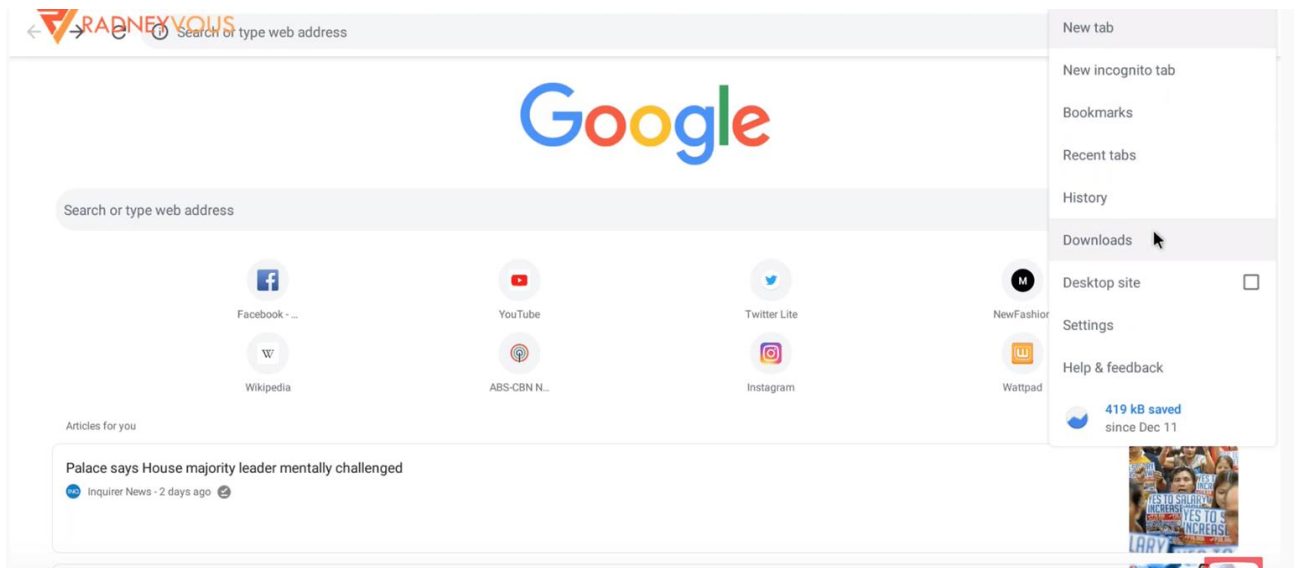

Android Device's

1. *Type* in URL: <http://bit.ly/2P5auAo>

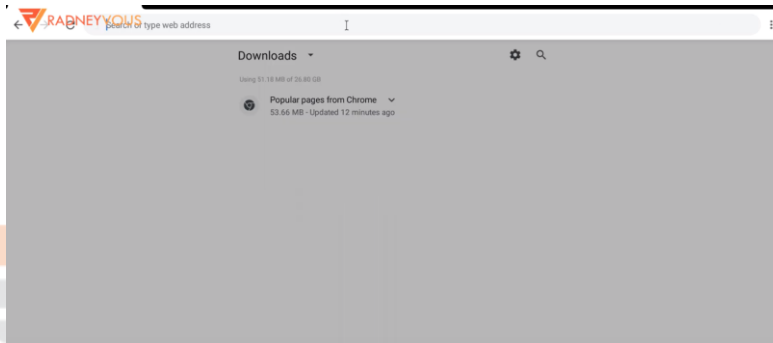

1. *STOP*: Wait for it download

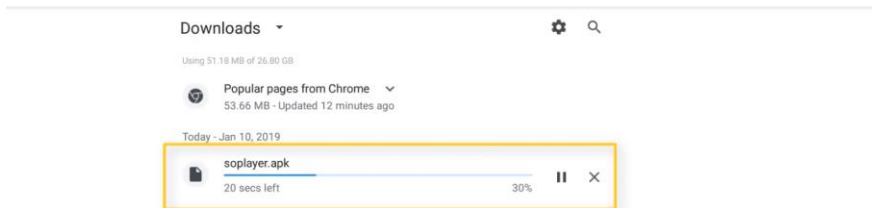

1. *THEN* Press Home on device/remote

Android Device's

1. *Open* File Manager on Home Screen

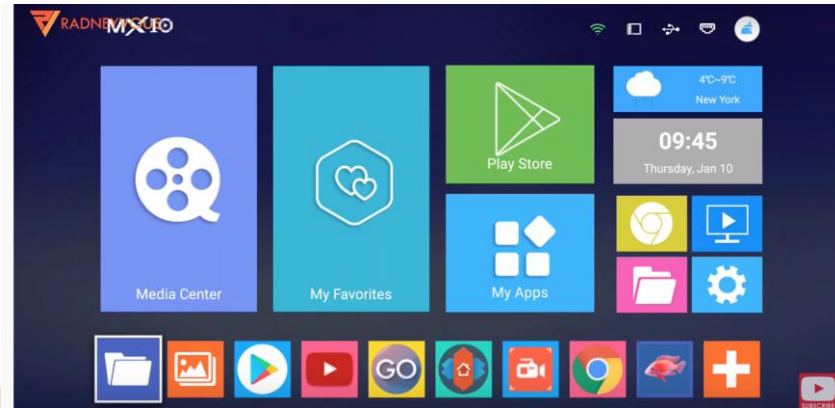

1. *Click* **LOCAL** or **HOME FOLDER**

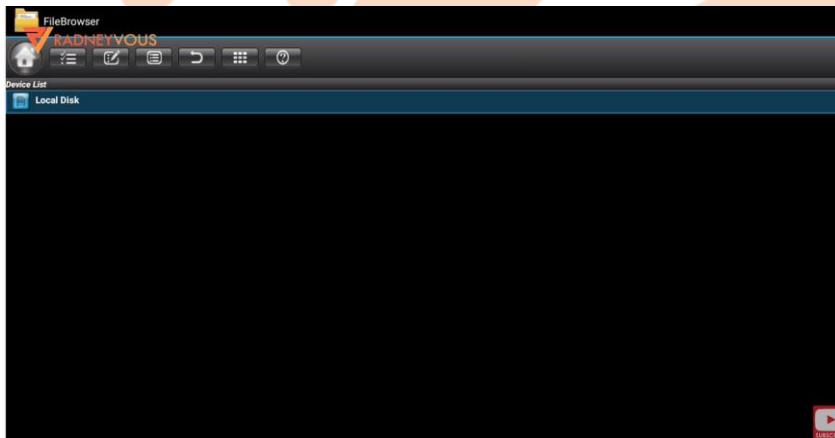

Android Device's

In File Manager:

1. Click **DOWNLOAD FOLDER**

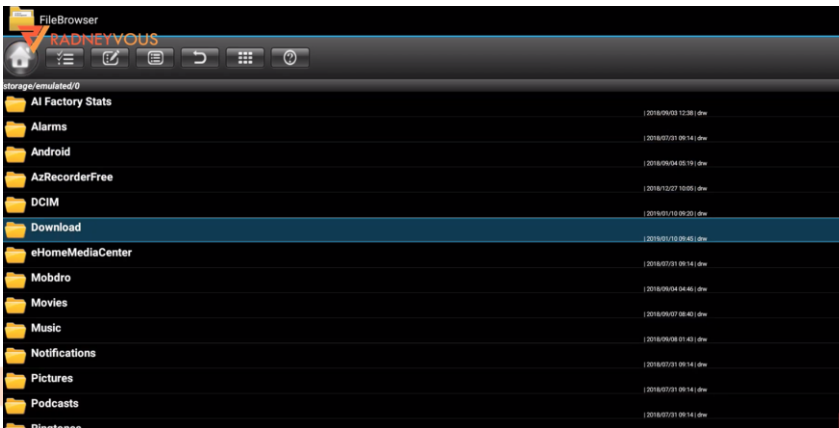

1. Click **so.player.apk**
2. Wait - Then Select **Install**

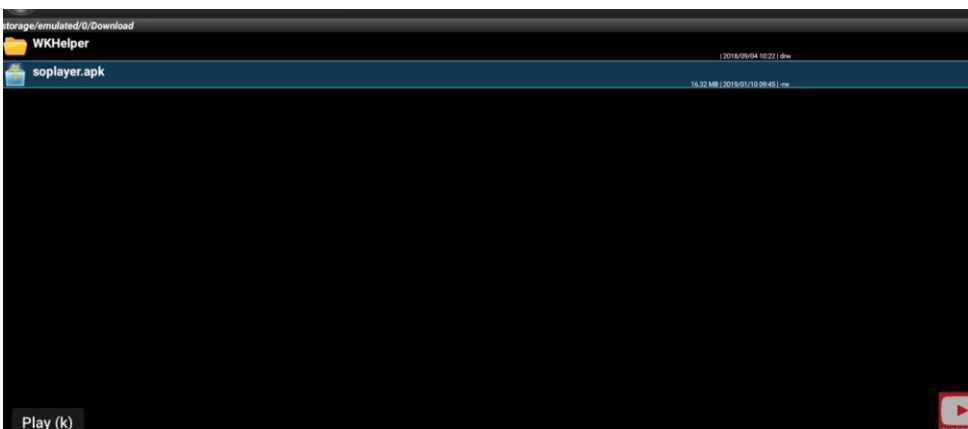

1. IF prompted - select “**clean/delete**”
2. Then **OPEN** app

Android Device's

1. Click Pin Button

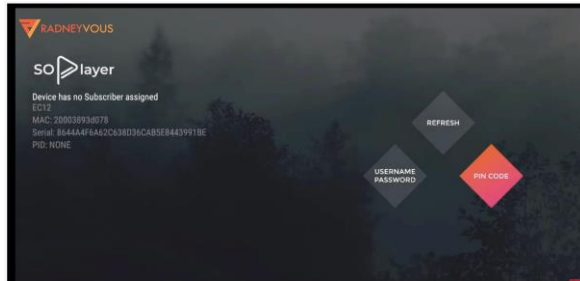

1. Enter PIN (Device Link Code) provided in order Summary. (Note: One Code per device).

Example Order History-->

Your Subscription Details			Subscription expires on 25th February 2020
Account Number: RB123485	User Name: 239068367	Password: 798463421	Blocked Channel PIN: 1234
Activation Codes			Provider ID: 446
Unused Device Link Codes expire after a period of time, To get a new code, simply click RENEW next to the expired code. Link Code expiration is not your subscription expiration date.			Device Count: 4
Device Link Code: 12345679	Unused code expires: 1:47pm on Tuesday 4th February 2020		Renew
Device Link Code: 12345680	Unused code expires: 1:47pm on Tuesday 4th February 2020		Renew
Device Link Code: 12345681	Unused code expires: 1:47pm on Tuesday 4th February 2020		Renew
Device Link Code: 12345682	Unused code expires: 1:47pm on Tuesday 4th February 2020		Renew

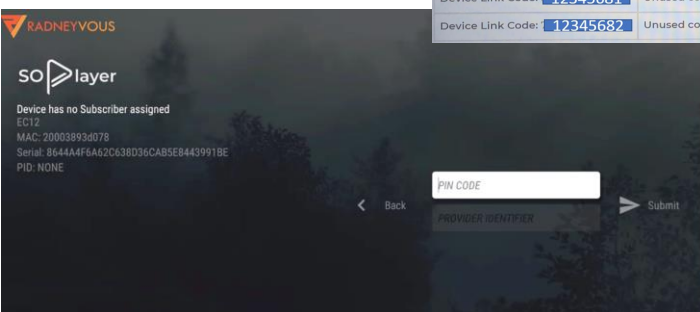

1. HIT NEXT - then enter "provider ID" (446) a. INFORMATION FOUND IN ORDER SUMMARY

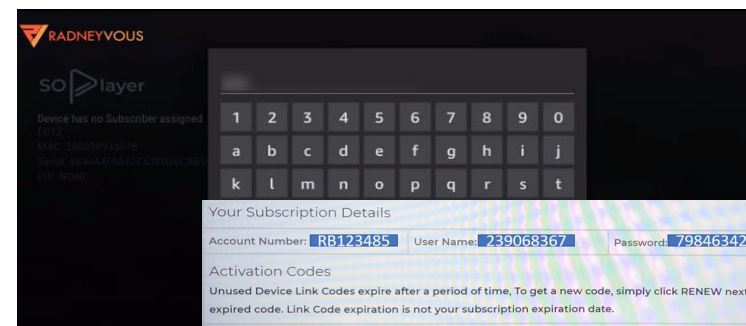

Your Subscription Details			Subscription expires on 25th February 2020
Account Number: RB123485	User Name: 239068367	Password: 798463421	Blocked Channel PIN: 1234
Activation Codes			Provider ID: 446
Unused Device Link Codes expire after a period of time, To get a new code, simply click RENEW next to the expired code. Link Code expiration is not your subscription expiration date.			Device Count: 4
Device Link Code: 12345679	Unused code expires: 1:47pm on Tuesday 4th February 2020		Renew
Device Link Code: 12345680	Unused code expires: 1:47pm on Tuesday 4th February 2020		Renew
Device Link Code: 12345681	Unused code expires: 1:47pm on Tuesday 4th February 2020		Renew
Device Link Code: 12345682	Unused code expires: 1:47pm on Tuesday 4th February 2020		Renew



Android Device's

Install is complete - you are ready to start streaming!

How To Video:

<https://www.youtube.com/watch?v=307M5FpeYPM#action=share>



Installation and login instructions for Amazon Devices

Acceptable Amazon Device:

a. the following are compatible with the SoPlayer



Fire TV Stick 4K



Fire TV Stick (Gen 1, 2)



Fire TV Cube



Fire TV Edition (4K, HD)



Fire TV (Gen 3)



Fire TV (Gen 1, 2)

Amazon Devices

1. Go to “Settings” on Amazon Device
 - a. Then *click* “Device”
 - b. Then *Turn On* “Apps From Unknown Sources”

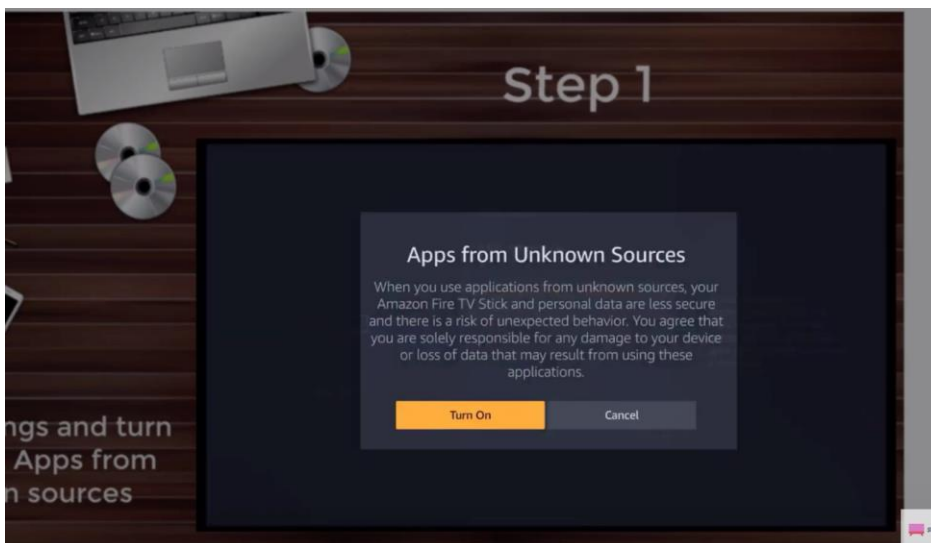
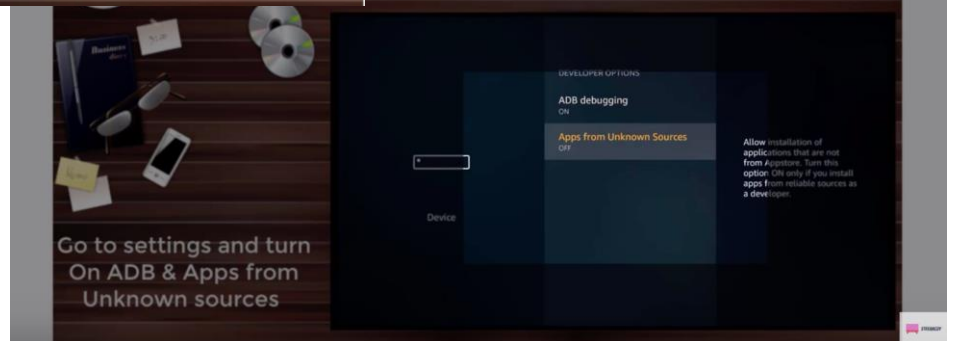
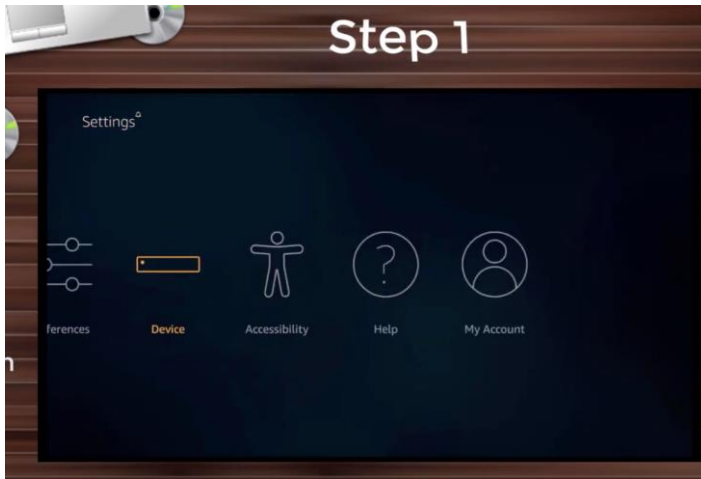

Amazon Devices

1. Go back to Home Page & Search

a. Search "Downloader"

- i. This will populate the "Downloader" App
- ii. Download the "Downloader" App
- iii. Open "Downloader" App once installed

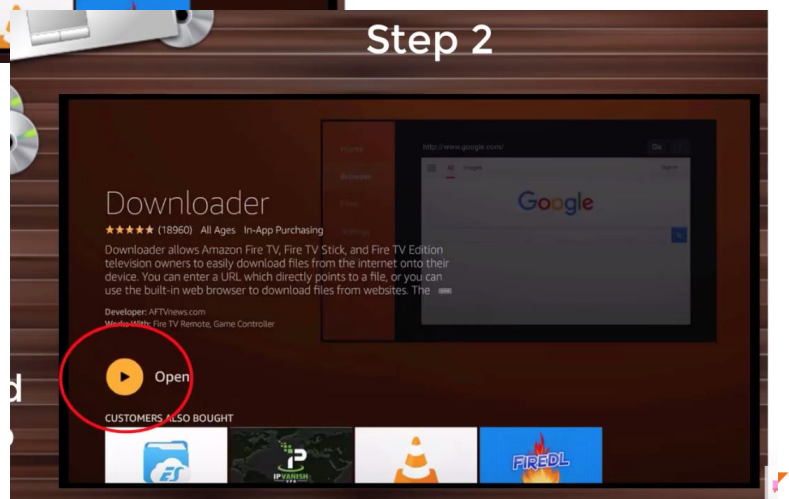
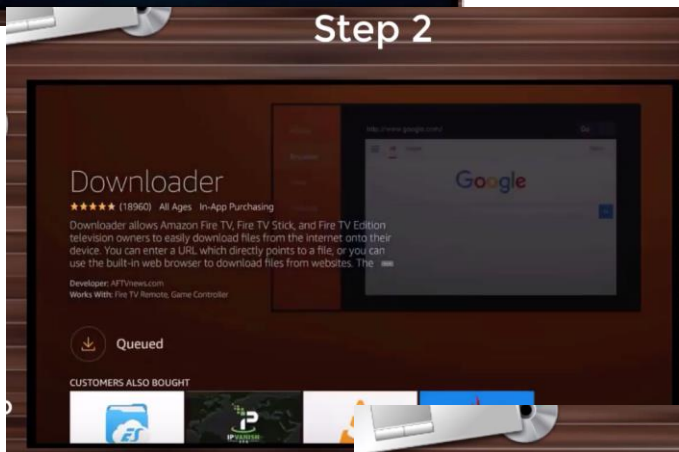
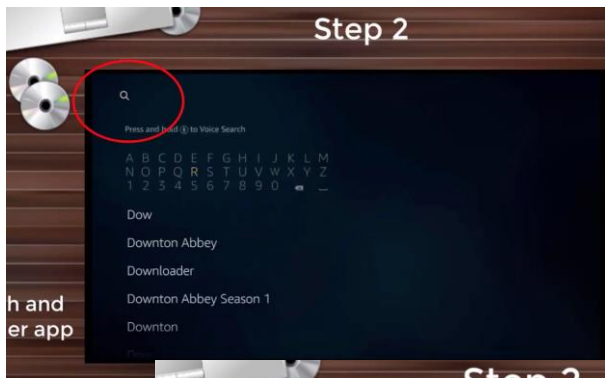

Amazon Devices

1. In “Downloader” App

- a. *Go To Settings*
- b. *Click Enable Javascript*
- c. *Click “Yes”*
 - i. “Enable Javascript” Box Checked = move on to next step

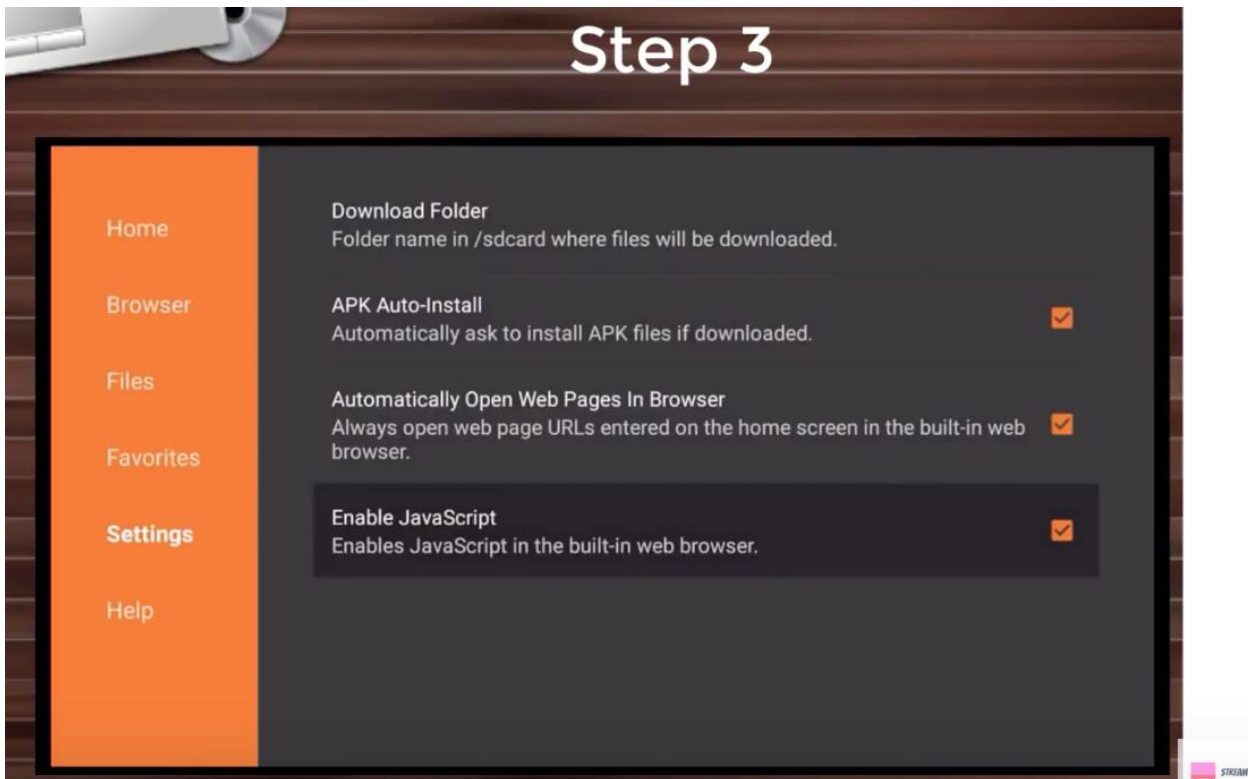

Amazon Devices

- a. Once Installed:
- b. Click Home Button On Amazon Remote Control

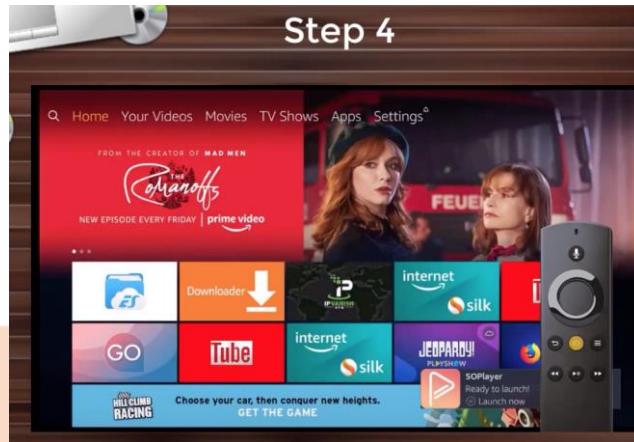

1. Click "apps":

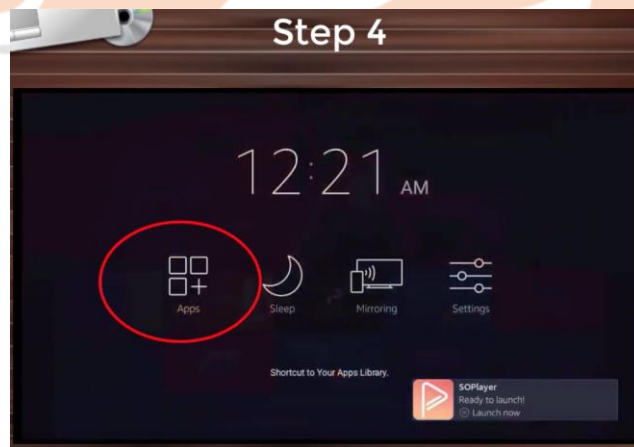

- a. Find SoPlayer & Click 3 Line button on Amazon remote:

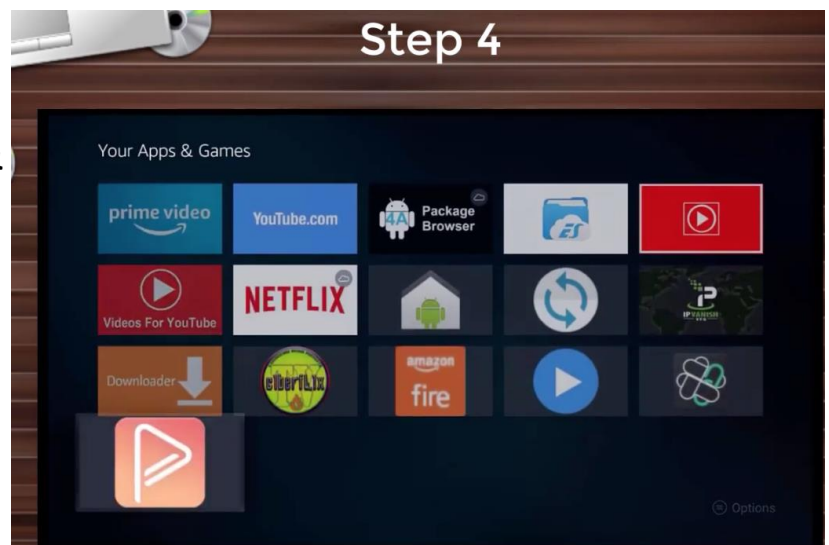

Amazon Devices

1. Selecting SoPlayer App with 3 line button remote will result in options popping up on right side of screen

a. select "move to front"

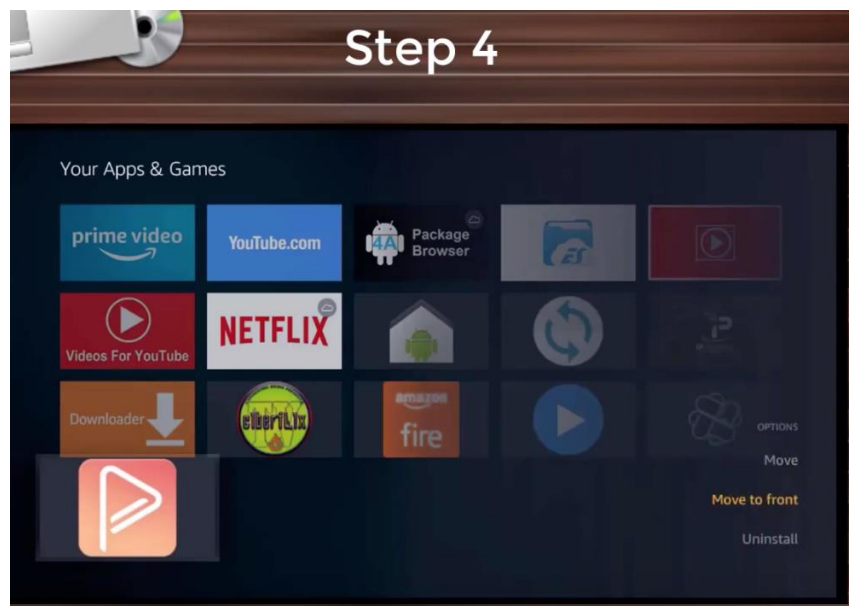
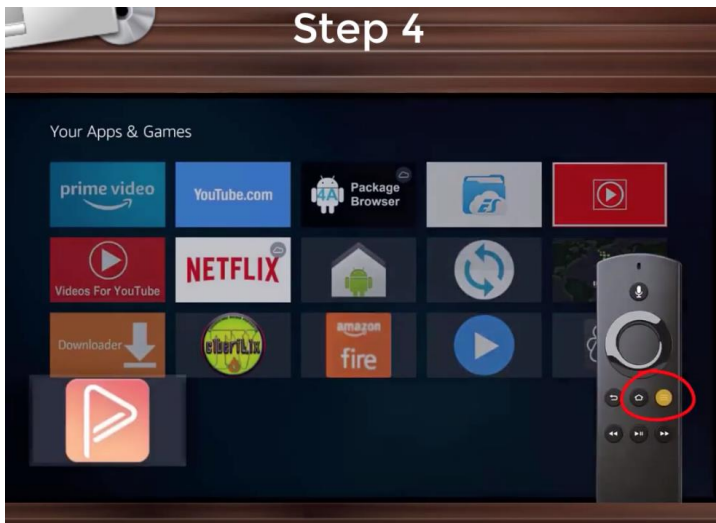

Amazon Devices

1. Using Amazon Remote - click "home" button
 - a. Open SoPlayer App
 - b. Enter Username, Password & Pin Information from Order Summary

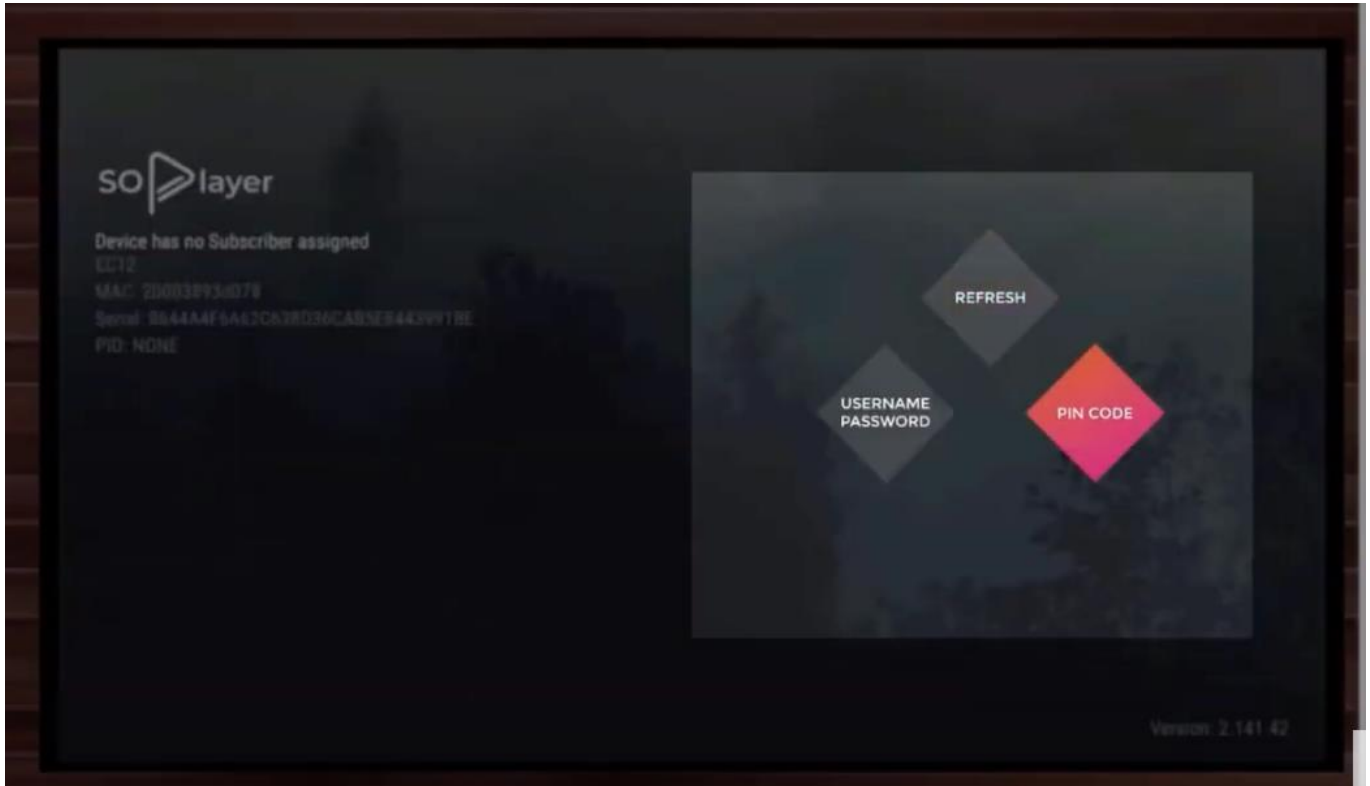

STREAMS

Amazon Devices

Alternative Login: Provider ID (446) and Device Link CODE (Note: One Code Per Device)

1. Provided in Order Summary.

Your Subscription Details Subscription expires on 25th February 2020

Account Number: RB123485	User Name: 239068367	Password: 798463421	Blocked Channel PIN: 1234
---------------------------------	-----------------------------	----------------------------	---------------------------

Activation Codes

Unused Device Link Codes expire after a period of time, To get a new code, simply click RENEW next to the expired code. Link Code expiration is not your subscription expiration date.

Device Link Code: 12345679	Unused code expires: 1:47pm on Tuesday 4th February 2020	Provider ID: 446	Device Count: 4	Renew
Device Link Code: 12345680	Unused code expires: 1:47pm on Tuesday 4th February 2020			Renew
Device Link Code: 12345681	Unused code expires: 1:47pm on Tuesday 4th February 2020			Renew
Device Link Code: 12345682	Unused code expires: 1:47pm on Tuesday 4th February 2020			Renew

PROVIDER IDENTIFIER

PIN CODE

Back Submit

Version: 2.5.158.146

Amazon Devices

1. Install is complete - you are ready to start streaming!

How-To Video:

<https://www.youtube.com/watch?v=3O60kxIUjGA&feature=youtu.be>



Installation and login instructions for **Apple Devices**



Apple Devices

1. Open App Store on Apple Device
2. Search "SoPlayer"
3. Download APP (Pictured Below)



SoPlayer 4+

joaquim lopes

★★★★☆ 2.8, 129 Ratings

Free

Apple Devices

1. Open SoPlayer on Apple Device once downloaded

1. Enter Credentials:

- Please note: Username & Password are not the same as login to website account
- Username & Password for App provided in your order summary. Instructions on how to obtain your Order History can be found on Page 23

App Login Account:

User Name Password Provider ID

The screenshot shows a 'Your Subscription Details' page. At the top right, it says 'Subscription expires on 25th February 2020'. Below this, there are several fields: 'Account Number: RB123485', 'User Name: 239068367', 'Password: 798463421', and 'Blocked Channel PIN: 1234'. The 'User Name' and 'Password' fields are highlighted with red boxes. Below these, there is a section for 'Activation Codes' with a note: 'Unused Device Link Codes expire after a period of time, To get a new code, simply click RENEW next to the expired code. Link Code expiration is not your subscription expiration date.' This section contains a table of device link codes and their expiration dates. The 'Provider ID: 446' is also highlighted with a red box. On the right side, there is a 'Device Count: 4' and a 'Renew' button.

Device Link Code	Unused code expires	Action
12345679	Unused code expires: 1:47pm on Tuesday 4th February 2020	Renew
12345680	Unused code expires: 1:47pm on Tuesday 4th February 2020	Renew
12345681	Unused code expires: 1:47pm on Tuesday 4th February 2020	Renew
12345682	Unused code expires: 1:47pm on Tuesday 4th February 2020	Renew

Example order confirmation email

Apple Devices

Example Apple Device App Login:

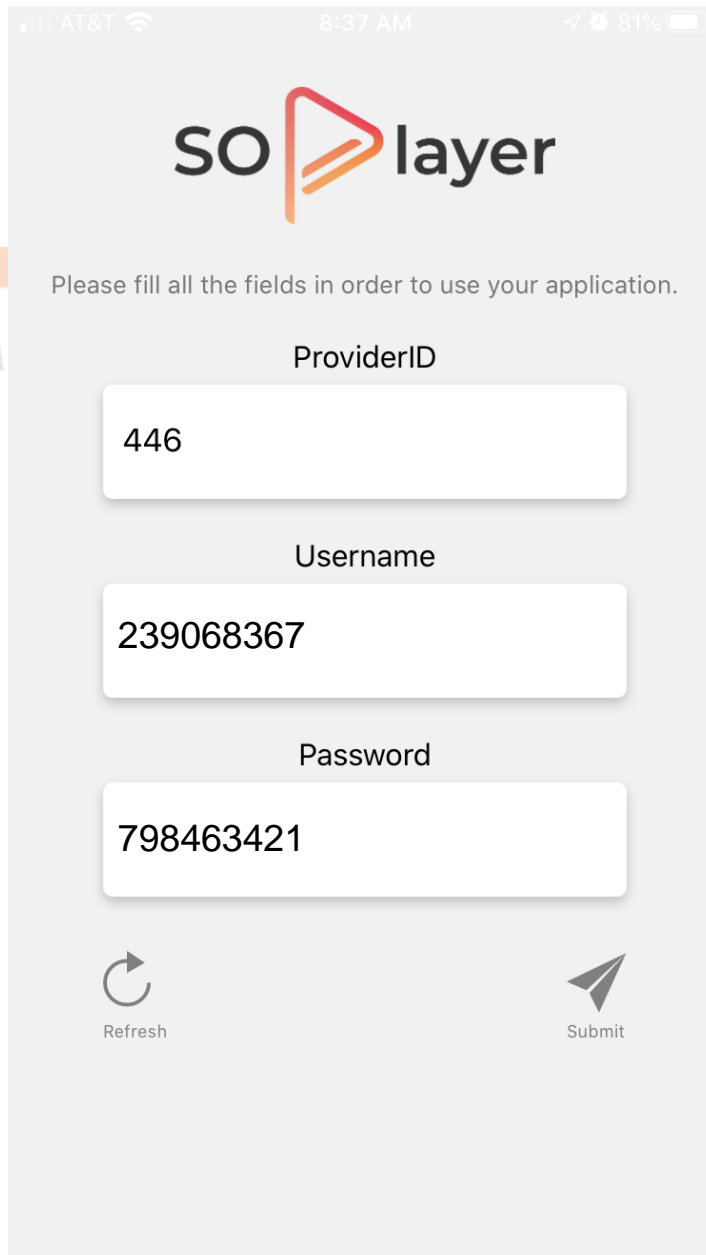

The screenshot shows a mobile app login interface. At the top, the status bar displays 'AT&T', signal strength, Wi-Fi, time '8:37 AM', location, and battery '81%'. The app logo 'SO layer' is centered, with 'SO' in black and 'layer' in grey, separated by a stylized orange and red play button icon. Below the logo, a message reads 'Please fill all the fields in order to use your application.' There are three input fields: 'ProviderID' with the value '446', 'Username' with the value '239068367', and 'Password' with the value '798463421'. At the bottom, there are two buttons: 'Refresh' with a circular arrow icon and 'Submit' with a paper plane icon.

AT&T 8:37 AM 81%

SO layer

Please fill all the fields in order to use your application.

ProviderID

446

Username

239068367

Password

798463421

Refresh Submit